



SMD Shielded Tiny Power Inductor Size 3012

- Magnetic resin for higher current and semi-magnetically shielded
- Quantity: 2000pcs

- DC/DC converter
- LC filter

Dimensions: [mm]

Land Pattern: [mm]

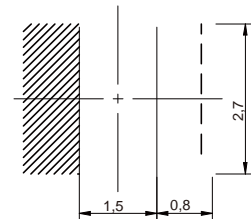

Electrical Properties:

	Tolerance	Saturation		
		(μ H)	(A)	(m)
		3.00	2.90	21
		2.20	2.20	33
		2.05	2.10	40
		1.90	2.00	48
		1.62	1.85	55
		1.50	1.70	68
		1.20	1.55	75
		1.05	1.35	100
		0.90	1.25	120
		0.80	1.10	160
		0.75	1.00	190
		0.60	0.89	265
		0.45	0.72	430
		0.42	0.55	630
		0.35	0.45	800
		0.36	0.46	875
		0.27	0.35	1450

Operating temperature: -40°C ~ +125°C

Temperature rise current: the actual value of DC current when the temperature rise is \leq 40°C

Saturation Current that will cause initial inductance to drop approximately 30%

